



**BASE RAIL BRACKET KIT - RAM 1500**  
 (WILL NOT FIT CLASSIC OR TRX MODELS)

Assembly, Installation, Operation,  
 and Maintenance Instructions

<b>PART NUMBER</b>	<b>33204</b>
<b>INSTALL TIME</b>	<b>90-120 MINUTES</b>

<b>DEALER / INSTALLER</b>	Provide a copy of these instructions to the end user of this product. These instructions provide important operating and safety information for proper usage of this product. Demonstrate the proper use of the product with the end user. Have the end user demonstrate that they understand the proper use of the product.
<b>END USER WARNING</b>	Read and follow all instructions included in this manual. Ask your Dealer/Installer for assistance if you do not understand the proper use of the product. Never remove any decals from the product. Failure to follow these instructions can result in injury or death.

**APPLICATION**

For use on RAM 1500 (WILL NOT FIT CLASSIC or TRX models)

<b>WARNING</b>	<b>DO NOT EXCEED</b> Recommended towing limits. <b>SEE VEHICLE'S OWNER'S MANUAL.</b>
----------------	--

**Use with 10 bolt 30686 base rails. Base Rails are not included with this kit.**

PARTS DIAGRAM

Meets SAE J2638 Standard

**FIGURE 1**

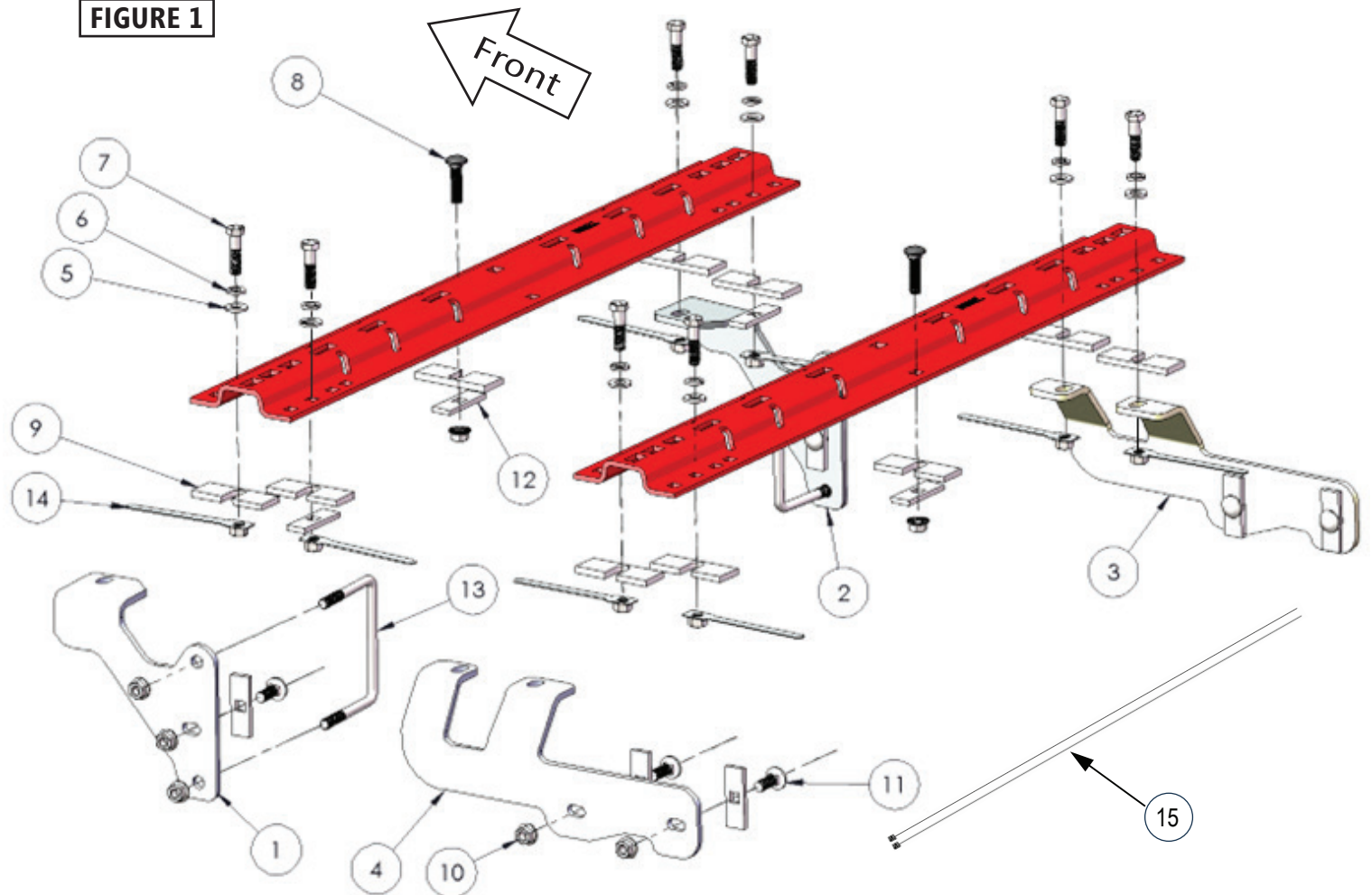

**⚠️ WARNING ⚠️**  
**CHOKING HAZARD**

**Small Parts.** Not for children under 5 years

### TOOLS REQUIRED

3/4" WRENCH & SOCKET

1/2" DRILL BIT

1/2" TRANSFER PUNCH

75 LB-FT. TORQUE WRENCH

SAFETY GLASSES

CONTENTS		33204 RAM 1500 BASE RAIL BRACKET KIT	31419 BASE RAIL 1/4" SPACER KIT
ITEM NO.	DESCRIPTION	QTY	QTY
1	DRIVER SIDE FRONT BRACKET	1	-
2	PASSENGER SIDE FRONT BRACKET	1	-
3	PASSENGER SIDE REAR BRACKET	1	-
4	DRIVER SIDE REAR BRACKET	1	-
5	1/2" HARDENED FLAT WASHER	8	-
6	1/2" HD LOCK WASHER	8	-
7	1/2" - 13 UNC X 2.0 HEX HEAD BOLT	8	-
8	1/2" - 13 X 2" CARRIAGE BOLT	2	-
9	SPACER PLATE	10	4
10	1/2" - 13 FLANGED SERRATED LOCKNUT	12	-
11	1/2" - 13 X 1-1/2" CARRIAGE BOLT	6	-
12	1/2" CARRIAGE BOLT SPACER	10	-
13	1/2" - 13 U-BOLT	2	-
14	1/2" - 13 NUT HANDLE ASSEMBLY	8	-
15	1/2" PULL WIRE	2	-

## WARNINGS/SAFETY PRECAUTIONS

1. The following instructions should be used to mount the base rail. Care and attention to detail will ensure a quick quality installation. Check parts against parts list to become familiar with parts in kit.
2. Raise rear of truck high enough to allow jack stands to be placed under rear spring hanger bracket of truck. This will provide maximum room to install the fifth wheel brackets.



**WARNING:** If the truck is raised, be sure that the truck is properly blocked and restrained to prevent the truck from falling. Failure to do so may result in the truck suddenly falling, causing death or serious injury.

3. Do NOT install base rails over plastic bed liners or bed mats. Plastic bed liners must be cut out of the way. Base rails may be installed on dry/cured spray in liner. Note: Consult installer for recommended curing time.
4. Use only the supplied bolts, nuts, and washers to install this kit. All nuts and bolts are Grade 5 unless specified otherwise.



**WARNING:** These instructions are guidelines only. Actual installation is the responsibility of the installer and the owner. Always measure truck and trailer before installing hitch to be sure that there is clearance at the cab and at the bumper to allow for turns.

5. The rear wheel well liners and the spare tire will need to be removed to access the frame for bracket installation. Removing the rear wheels is not mandatory but can greatly decrease the number of obstacles when performing the installation. See **Figure 2**.
6. Measurements are given from the rear edge of truck bed to rear edge of the closest base rail.
7. Place the two base rails across the truck bed between the wheel wells. Position the 5th wheel uprights between the base rails so that the tabs in the base of each upright will fit into the slots in the ends of the bed rails. Secure the uprights in place with the rail hitch pins and hair pins supplied with the 5th wheel installation kit. Securely attach 5th wheel cross member to uprights.



**WARNING:** Check for obstructions before drilling. Failure to do so could result in damaged fuel or brake lines, structural members, etc. HUSKY TOWING PRODUCTS does its best to communicate tow vehicle manufacturer changes; however, it is ultimately the responsibility of the installer to prevent damage due to installation.



Plastic Wheel Well liner installed



Plastic Wheel Well liner



Plastic Wheel Well liner Removed

**FIGURE 2**

**NOTE:** To keep the trailer from hitting the cab on tight turns, there must be at least 52" between the center of the hitch and the cab. A roller/glider should be used when installing a fifth wheel with a truck bed shorter than 8'. Consult the Husky Towing Products catalog to select the product that best matches your needs.

8. On most applications, the 5th wheel assembly should be positioned so that it is approximately centered over the truck axle and between the wheel wells on the bed floor. See **Figure 3**.

9. When the hitch is correctly positioned in the bed and the bed rails are parallel (See **Figure 3** for measurements) mark the four attachment points on the truck bed using the 1/2" square holes towards the ends of each bed rail as a guide. The use of a 1/2" transfer center punch will ensure that the marks are correctly marked on the bed floor. **Check below the bed before drilling holes to ensure that all wiring, brake lines or other obstructions are moved out of the way and will not be contacted by the drill bit.** Move the hitch assembly out of the way and drill eight 1/2" diameter attachment holes down through the bed at the previously marked points.

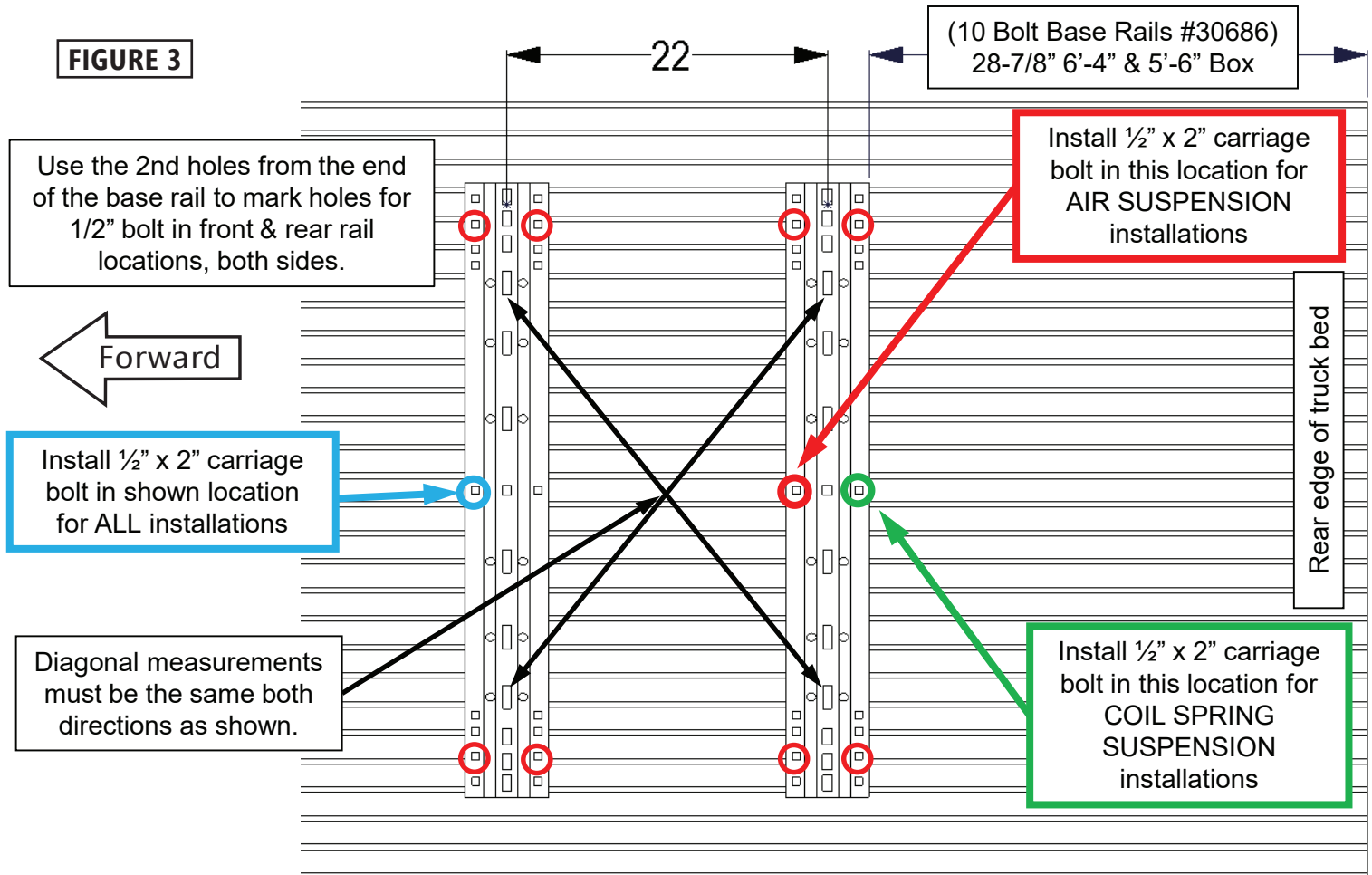

10. Reposition the bed rails in the bed so that the square 1/2" hole in the end of each rail is lined up over the drilled holes. See **Figure 4**. Place spacer plates (#9) under both ends of each bed rail, in line with the drilled holes as shown in **Figure 4**.

**FIGURE 4**

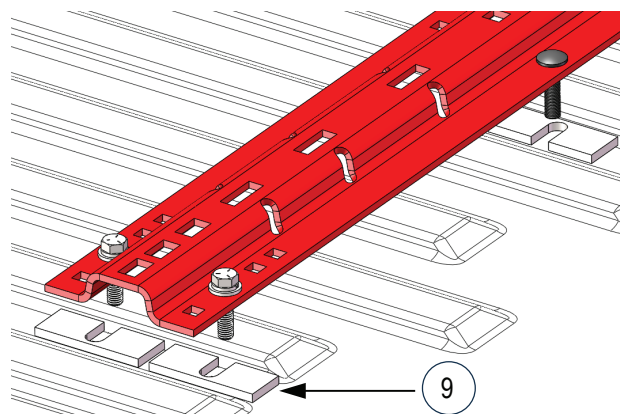

11. Thread a pull wire (#15) onto a 1/2" - 1-1/2" carriage bolt (#11) and pass the wire through the spacer plate (#12). See **Figure 5**. Pass the bolt and the spacer plate through the hole in the frame as shown. Then pass the pull wire through the center hole in the Front Bracket (#1). See **Figure 6**. (Driver's side shown).

**FIGURE 5**

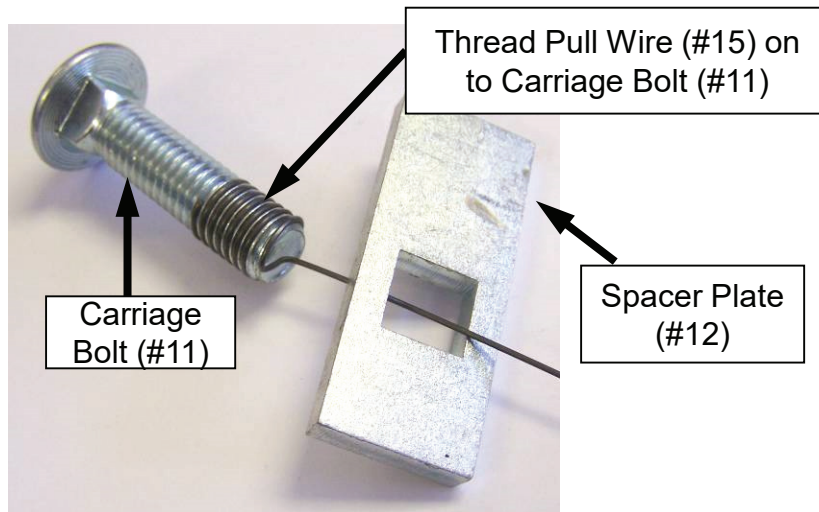

12. Pull the bolt with the plate tight to the truck frame. The square shank on the bolt must be in the square hole on the plate. Slide the bracket into place and install a flanged lock nut and tighten lightly.

13. Install the U bolt (#13) around the frame and through the remaining bolt holes and install 2 flanged lock nuts (#10) tighten tightly. See **Figure 6**.

14. Repeat for the passenger side of the truck.

**FIGURE 6**

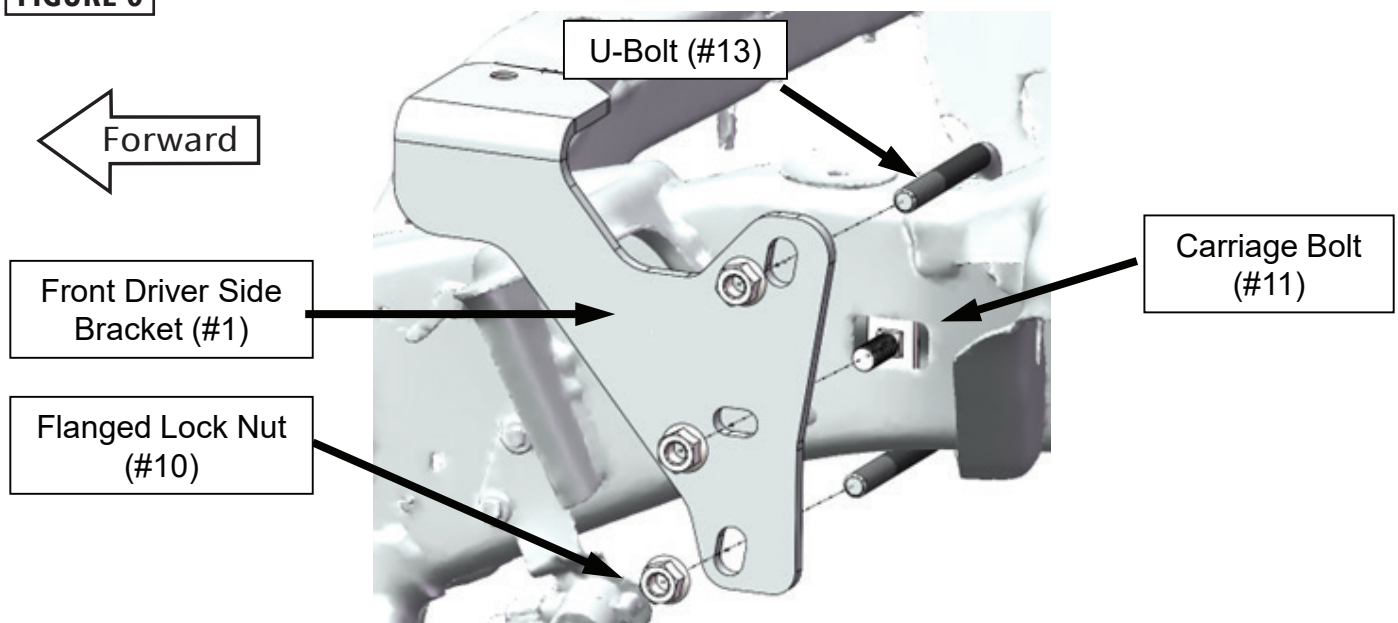

15. Thread a pull wire (#15) onto a ½" - 1-1/2" carriage bolt (#11) and pass the wire through the spacer plate (#12). See **Figure 5**. Pass the bolt and the spacer plate through the hole in the frame as shown. Then pass the pull wire through the front hole in the Rear Bracket (#4). See **Figure 7**. (Driver's side shown).
16. Pull the bolt with the plate tight to the truck frame. The square shank on the bolt must be in the square hole on the plate. Slide the bracket into place and install a flanged lock nut and tighten lightly.
17. Repeat steps 15 & 16 for the rear hole in the Rear Bracket. See **Figure 7**.
18. Repeat for the passenger side of the truck.

**FIGURE 7**

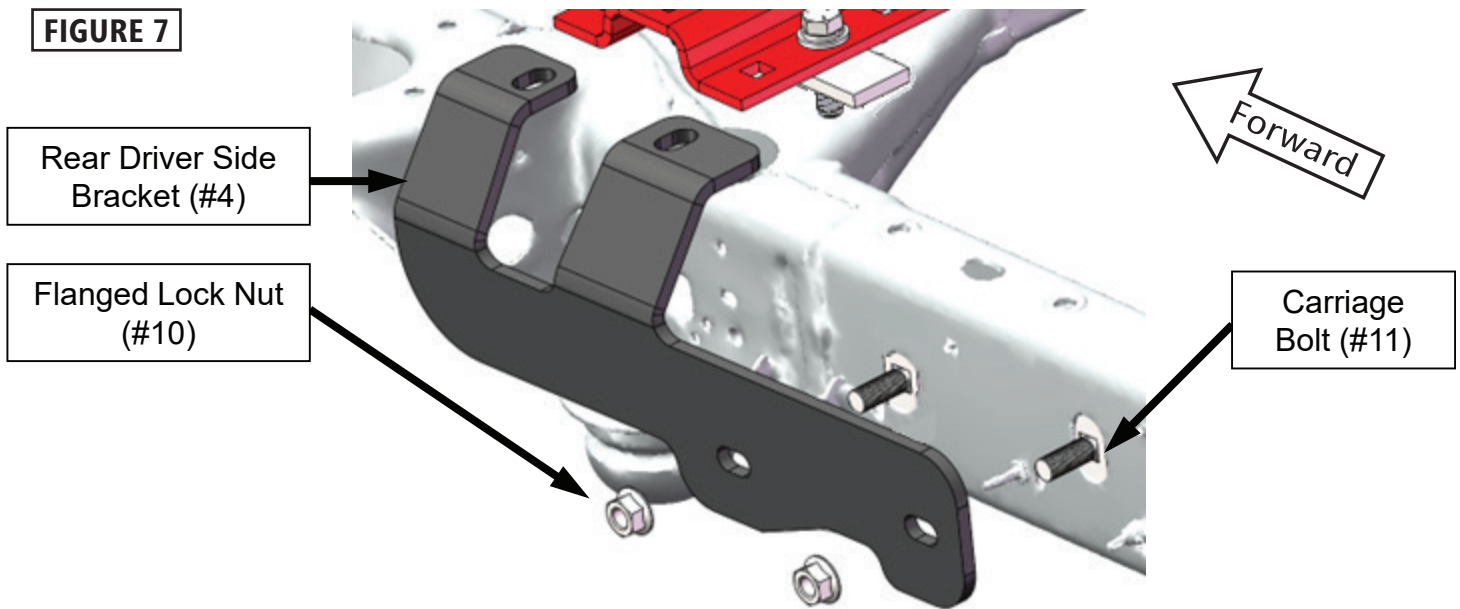

19. Install ½" hex bolts (#7), ½" lock washer (#6), and ½" flat washer (#5) through the base rails in each of the 8 holes drilled in Step 9. See **Figure 8**.

**FIGURE 8**

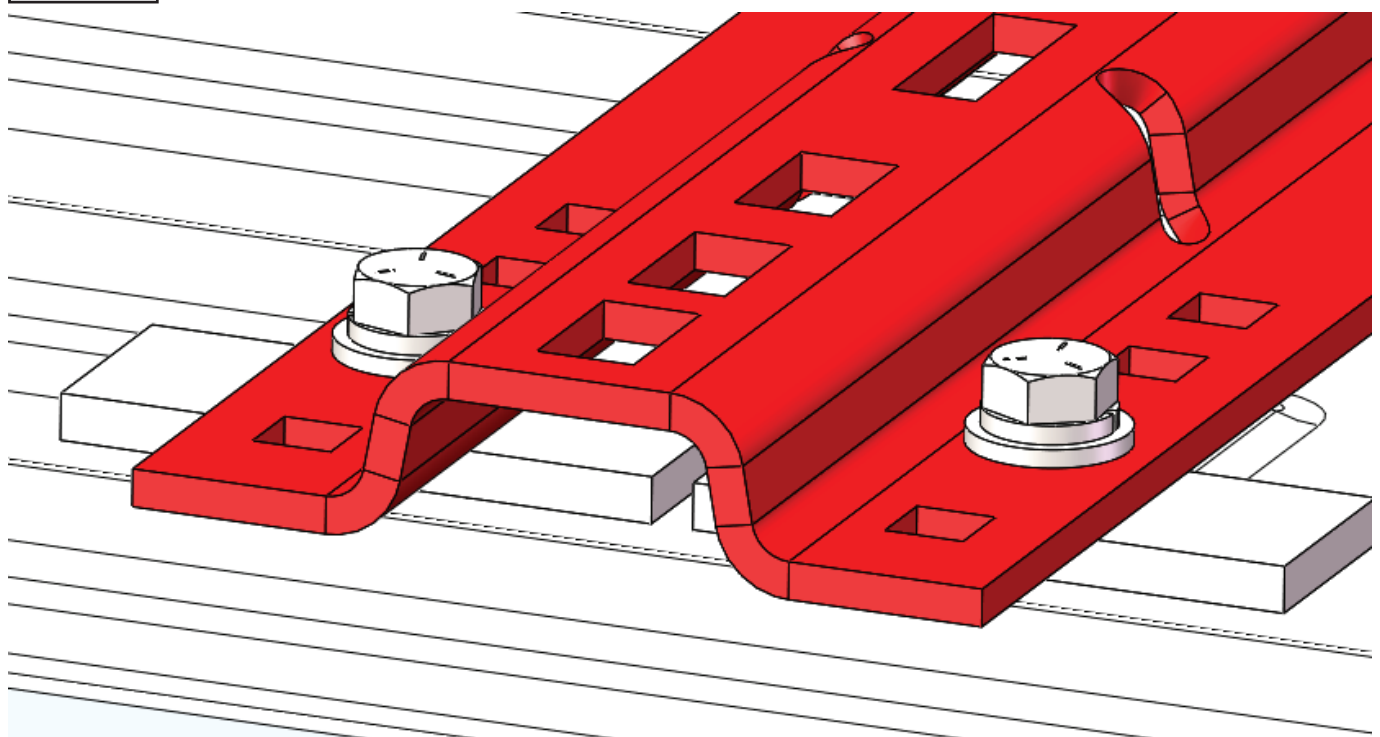

20. Install nut handle assemblies (#14) onto the 1/2" hex bolts (#7) installed in step 19 on the rear brackets (#3 & #4). Driver side shown in **Figure 9**.

**FIGURE 9**

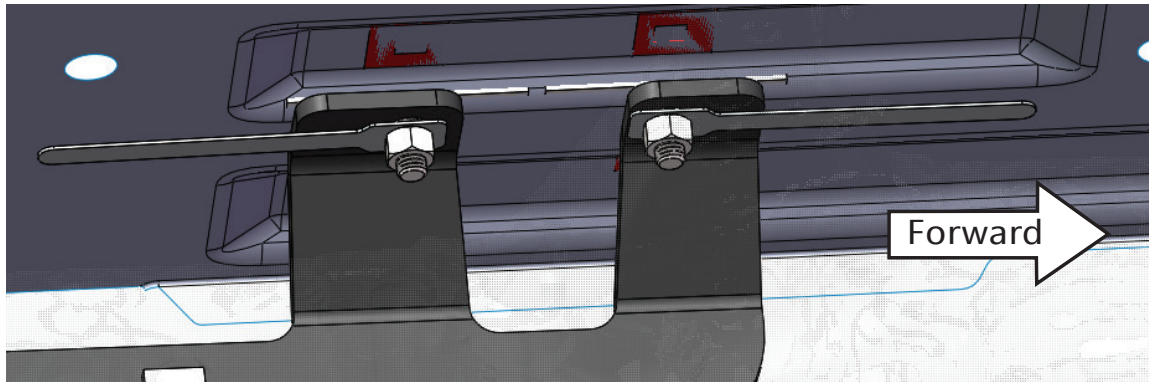

21. Install nut handle (#14) onto the 1/2" hex bolts (#7) installed in step 19 on the front brackets (#1 & #2). The Driver side shown in **Figure 10**. A 1/2" carriage bolt spacer (#12) MUST be installed on the rear 1/2" bolt between the truck bed and the nut handle. See **Figure 10**.

22. Tighten all 1/2" attachment fasteners to 75 lb-ft Failure to tighten bolts as described may result in fastener loss or failure.

**FIGURE 10**

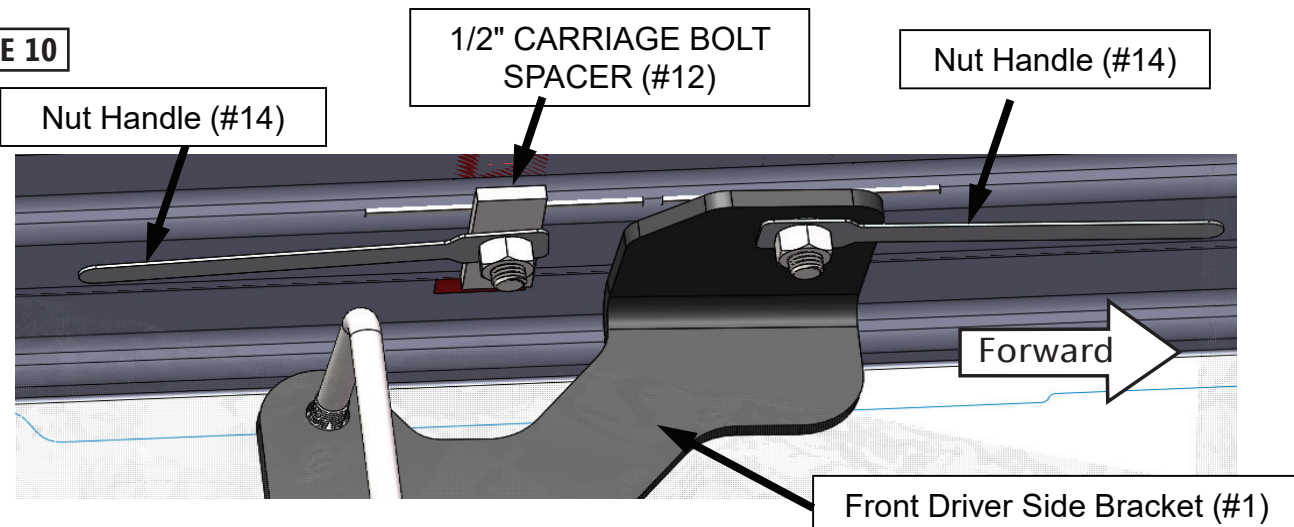

Your installation should look like **Figure 11**.

**FIGURE 11**

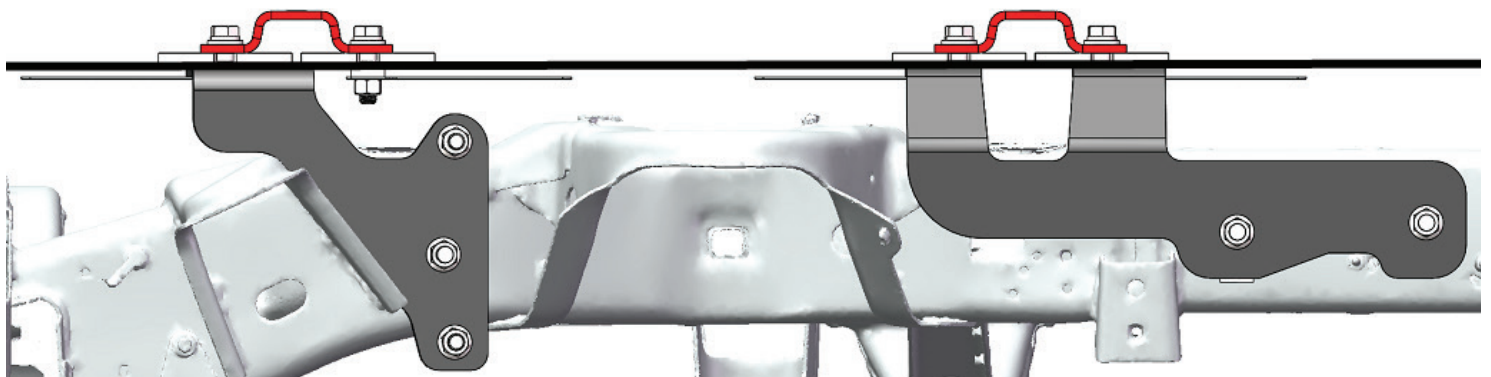

# CENTER BOLT INSTALLATION

23. Locate the correct hole location in each base rail. Using these holes as a guide, drill a 1/2" hole through the truck bed. See **Figure 12**.

**FIGURE 12**

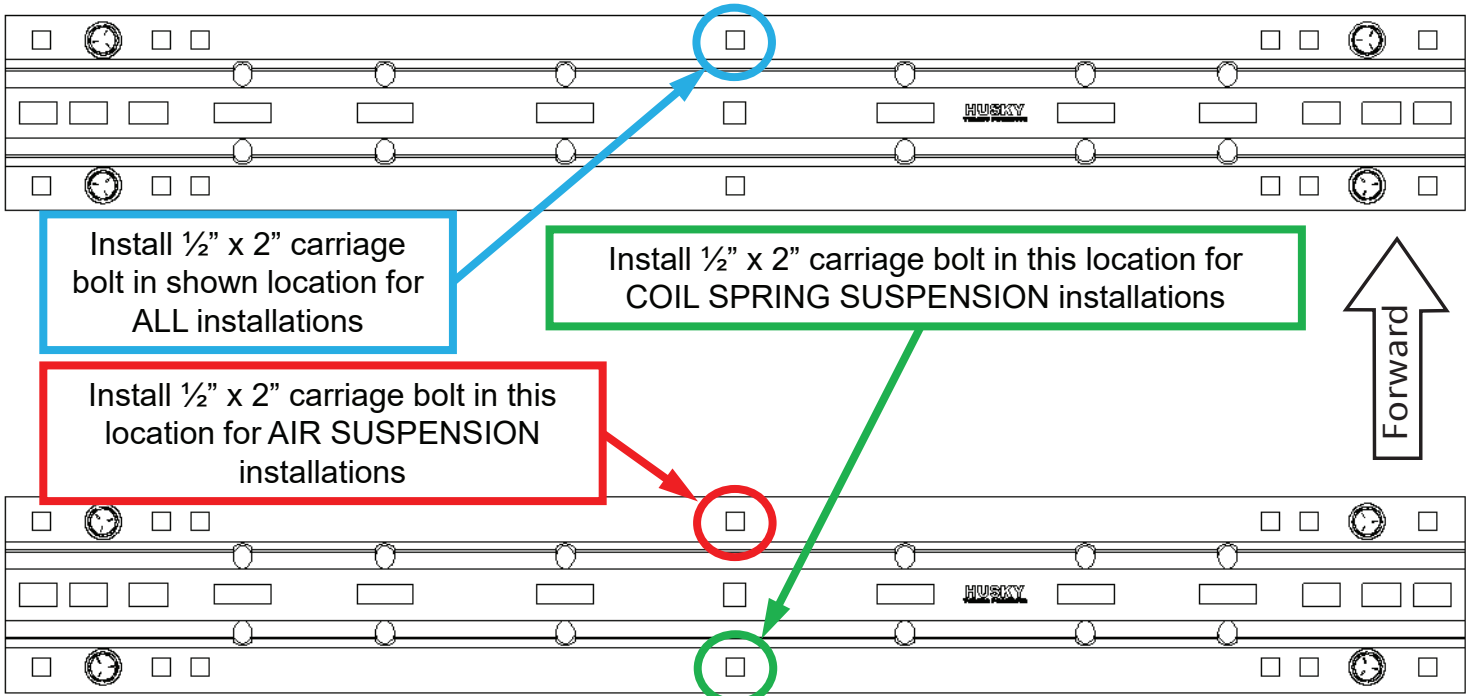

24. Install the 1/2" X 2" carriage bolts (#8) through both base rails and truck bed in the indicated locations shown in **Figure 12**.

25. Place the spacer plates in the correct position between the base rails and truck bed. See **Figure 13**.

**FIGURE 13**

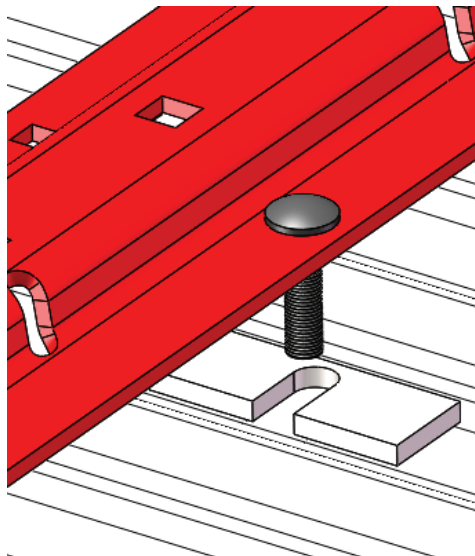



26. Install 1/2" carriage bolt spacers (#12) and 1/2" flanged serrated locknuts (#10) as shown at both base rail locations. See **Figure 14**. Torque bolts to 75 lb-ft.

**FIGURE 14**

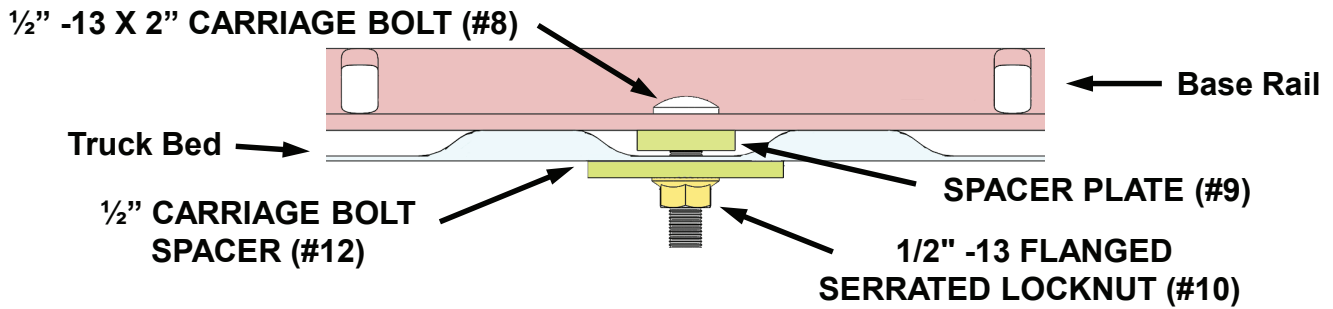

27. Check each rail hitch pin for freedom of movement in the bed rail connection. Adjust uprights, if necessary, by placing shim between the upright and the cross member to obtain free pin movement. See **Figure 15**.

**FIGURE 15**

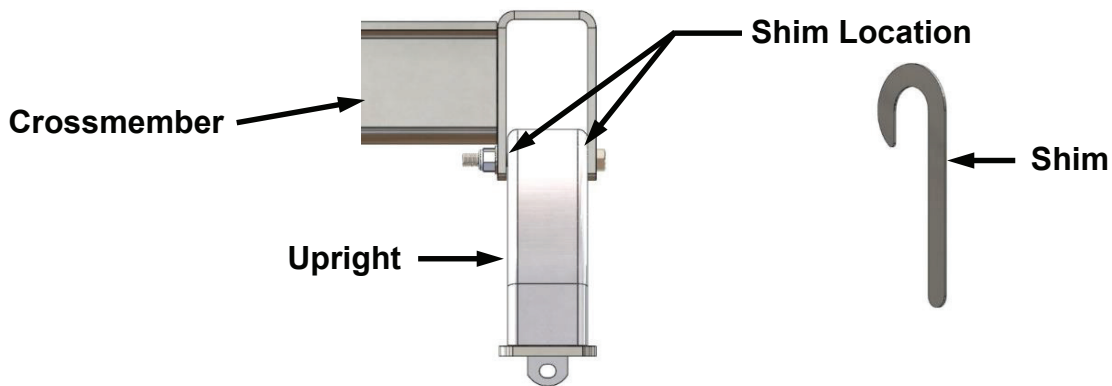

28. Re-install the rear wheel well liner, the rear spare tire, and any removed wheels. You have completed the installation of your bracket kit.

## MAINTENANCE

1. Inspect the hitch and installation kit each time before connecting a trailer, check to ensure all fasteners are tight and there are no cracks or excessive wear.
2. Check hardware for correct torque after first 100 miles, and annually thereafter.

## FAQS

PROBLEM	WHAT TO LOOK FOR	SOLUTION
<b>Hitch is difficult to install and remove from the base rails</b>	Hitch is not assembled correctly.	Refer to Hitch Assembly section for proper assembly instructions.
	Base Rails are not parallel with each other.	Use spacer or 5th wheel uprights to hold both base rails parallel while loosening and retightening the carriage bolts.
	Truck bed collapsing around carriage bolts in base rails.	Install proper spacers between the base rail and corrugations. Refer to installation instructions for specific directions.

# WARRANTY

## TECH & WARRANTY SUPPORT:

**PHONE:** 877-544-4449

**EMAIL:** warranty@lkqspg.com

**FAX:** 855-485-1195

## WARRANTY TERMS

### Limited Lifetime Warranty:

Husky Towing Products and Keystone Automotive Operations Inc. make no guarantees or warranties for products not manufactured by Keystone Automotive Operations Inc. Such products are covered solely under any applicable warranty of the manufacturer. It is always recommended that the operating instructions and warranty instructions provided by the manufacturer are followed.

Keystone Automotive Operations Inc. warrants its products to be free from manufacturing and material defects to the original purchaser for the length of warranty stated above from the date of retail purchase. If any products are found to have a manufacturing or material defect, the product will be replaced or repaired at the option of Husky Towing Products and Keystone Automotive Operations Inc. with proof of purchase by the original purchaser. The original purchaser shall pay all transportation and shipping costs associated with the return of the defective product and the defective product shall become the property of Keystone Automotive Operations Inc.

The Warranty applies to Keystone Automotive Operations Inc. products used for individual and recreational purposes. Commercial usage of the Keystone Automotive Operations Inc. products limits the warranty to 90-days from date of purchase.

The Warranty applies only to Keystone Automotive Operations Inc. products which are found to be defective in manufacturing or material. This warranty does not apply to normal wear and tear of the finish placed on Keystone Automotive Operations Inc. products.

Husky Towing Products and Keystone Automotive Operations Inc. are not responsible for any labor costs incurred for removal or replacement of the defective product.

Husky Towing Products and Keystone Automotive Operations Inc. are not responsible for repair or replacement of any product under the limited warranty where the product was improperly installed, misapplied, altered, abused, neglected, overloaded, misused or damaged as a result of an accident, including any use of the product not in accordance with all product operating and safety instructions.

Without limiting the generality of the foregoing, Husky Towing Products and Keystone Automotive Operations Inc. shall under no circumstances be liable for any incidental or consequential loss or damage whatsoever arising out of, or in any way relating to any such breach of warranty or claimed defect in, or non-performance of the products. Some states do not allow the exclusion or limitation of incidental or consequential damages, so the above exclusion or limitation may not apply to you.

This limited warranty gives you specific legal rights, and you may also have other rights that vary from state to state.